

# Capability Statement

Below Ground Waterproofing Experts

View Our Services



BALEH CONSULTING PTY LTD  
ABN 74 677 942 602

FIND US ON:





## 1. Who we are

**Baleh Consulting Pty Ltd** is a Sydney-based specialist consultancy focused on below-ground waterproofing, concrete durability, and remedial engineering for all Building Classes.

We support strata communities, developers, builders, consultants, and asset owners in delivering durable, compliant, and low-risk building outcomes across residential, commercial, and infrastructure projects, nationally and internationally, from basement to rooftop.

We provide clear, practical technical advice to manage one of the most critical risks in construction: **Water ingress and concrete deterioration.**

## 2. Our core values

### 2.1 Trust

We build enduring relationships through reliability, transparency, and consistent delivery on our commitments. Our clients and partners rely on us for clear advice, honest assessments, and dependable outcomes. By maintaining open communication and standing behind our work, we establish trust as the foundation of every engagement.



### 2.2 Integrity

We operate with accountability and ethical rigour, upholding the highest standards of honesty and professional conduct. Our decisions are guided by sound judgement, independence, and respect for all stakeholders. This commitment ensures credibility in our advice and confidence in our services across all project stages.



### 2.3 Client focus

We place our clients' objectives at the centre of everything we do, delivering tailored and practical solutions that respond to their specific needs. Through active listening, clear communication, and timely delivery, we create value and foster long-term partnerships built on performance and trust.



### 2.4 Competence

We bring deep technical expertise and a rigorous approach to every project, ensuring precise, reliable, and high-quality outcomes. Our commitment to continuous improvement, industry best practice, and innovation allows us to solve complex challenges and deliver effective, buildable solutions.



### 2.5 Growth

We continually strive for continuous learning and innovation to enhance our capabilities and stay at the forefront of our field. By investing in knowledge, systems, and people, we enhance our service offering and deliver increasing value to our clients over time.





### 3. What We Do - Our Services

#### 3.1 Below-Ground Waterproofing Design

Specialist design of high-performance waterproofing systems for basements and all below-ground structures. We review structural, architectural, drainage, and geotechnical designs and reports to deliver integrated solutions compliant with **NCC 2022**, the relevant **Australian Standards**, and the **DBP Act 2020**, in reference to **BS 8102:2022** and other international codes.

Experience across piling systems, diaphragm walls, shotcrete, in-situ, PVC walling, block work, and precast systems, for both drained and tanked structures, incorporating membranes, drainage systems, and integral technologies.



#### 3.2 Remedial Below-Ground Waterproofing

End-to-end diagnostic and remediation strategy for leaking or defective structures. Services include site investigation and assessment, cause analysis, and development of detailed, buildable repair specifications aligned with relevant local and international standards.

We ensure clarity, constructability, and effective risk mitigation for remedial works.



#### 3.3 Project Coordination & Hold Point Inspections

We provide various coordination services, such as:

- Independent and thorough site Hold Point inspections to ensure design intent is achieved on site.
- Attend meetings, respond to RFIs, and coordinate with third-party consultants and contractors on behalf of the client.
- Organise the invitations to tender, tender analysis, and assist in the administration of the contract.
- We represent client interests throughout delivery, ensuring compliance, coordination, and protection of critical systems.



### 3.4 Infrastructure Waterproofing and Remedial

Design and remediation solutions for complex infrastructure, including bridges, tunnels, marine structures, water facilities, substations, and critical assets. Focused on durability, constructability, and long-term performance through appropriate system selection and material optimisation.



### 3.5 Expert Consulting

Independent, specialist advice across:

- Peer reviews and technical due diligence
- Expert witness services
- Precast concrete consulting
- Concrete durability and waterproofing optimisation
- Condition assessments, inspections, and reporting

### 3.6 Knowledge Sharing

Delivery of technical training, workshops, and industry presentations, including associations and universities.

We support upskilling across the sector by sharing practical expertise in waterproofing, remediation, and concrete performance.



### 3.7 Above-Ground Waterproofing and Remedial Works

While below-ground waterproofing remains our core specialisation, we bring the same level of technical rigour, diagnostic capability, and design expertise to above-ground applications. Our experience extends to external exposed areas, rooftops, podiums, balconies, and internal wet areas within residential and commercial settings.

We assess and address water ingress, material deterioration, and construction defects through a forensic approach, ensuring that waterproofing systems and concrete repair strategies are not only compliant but fit-for-purpose and durable. Our services cover condition assessments, failure diagnostics, specification development, and remediation design, with a strong focus on long-term performance rather than short-term fixes.



## 4. Why Clients Engage Us

Strata managers, Owners Corporations, developers, builders, architects, and consultants engage **Baleh Consulting** when projects demand specialist expertise in waterproofing and concrete durability, particularly where below-ground complexity, failure, or risk is involved.

Clients choose us because we offer:

- A rare, specialist focus on below-ground waterproofing and durability engineering
- Independent, system-neutral advice free from supplier or contractor bias
- Deep forensic capability to diagnose root causes of water ingress and material failure
- Integration of structural, civil, and waterproofing early designs and analyses, resolving issues others treat in isolation
- Early-stage design engagement to prevent defects, not just rectify them
- Practical, buildable solutions grounded in real construction conditions
- Strong experience across live environments, complex basements, and high-risk assets
- The waterproofing systems we design are the last line of defence
- Trusted technical support in disputes, compliance, and expert advisory roles

Our methodology is based on evidence, not assumptions, and performance, not products. We focus on eliminating root causes and delivering durable, risk-informed outcomes, not temporary fixes.

## 5. Our Unique Approach

We integrate:

- Water shedding and secondary drainage strategies
- Performance-based waterproofing engineering
- Concrete durability science
- Structural and geotechnical interface behaviour
- Drainage, vapour, and hydrostatic pressure analysis
- Soil type analysis, including alluvium and colluvium assessments

Where applicable, our solutions align with:

- NCC 2022
- AS 3600 (Concrete Structures)
- AS 2870 (Residential slabs and footings)
- AS 3700
- AS 4654 series & AS 3740 (Waterproofing standards)
- TfNSW, VicRoads, or TMR durability requirements for infrastructure projects
- BS 8102:2022, CIRIA, EN 1504 and other international best practices for below-ground waterproofing and/or concrete repair guidelines.

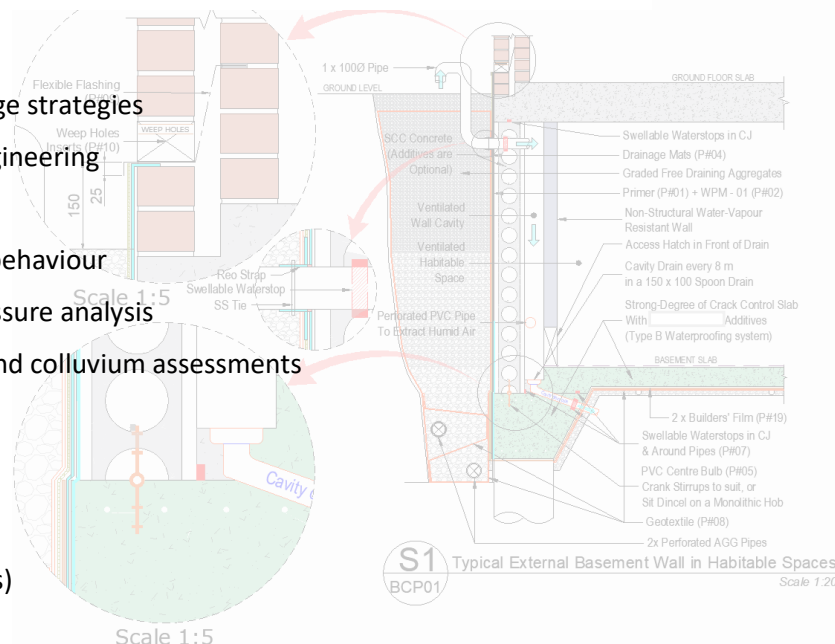



## 6. Value We Deliver

We help clients:

- Reduce lifecycle maintenance and repair costs
- Eliminate recurring waterproofing failures
- Improve asset durability and long-term performance
- Manage technical and financial risk
- Achieve compliant, buildable outcomes
- Deliver cost-effective, value-driven solutions

## 7. Our Difference

**Baleh Consulting** is a niche specialist, not a generalist engineering firm. We do not position ourselves as covering all disciplines; instead, we focus deeply on waterproofing system design, concrete repair, and concrete durability, where failure risk is highest, and specialist expertise is essential.

Our strength is depth over breadth. We concentrate on below-ground structures, basements, and critical building interfaces, areas where small detailing decisions have long-term consequences. This focused expertise allows us to interrogate design, materials, and construction sequencing at a level that generalist practices typically do not provide.

What makes us distinct:

- A dedicated specialist focus on waterproofing and concrete durability engineering
- Deep technical understanding of below-ground performance and complex interfaces
- Engineering-led approach to waterproofing, not treated as a secondary or generic discipline
- Project-specific detailed technical drawings and specifications—never generic, always tailored to the actual structure, risks, and conditions
- Strong alignment between design intent, constructability, and real site conditions
- Clear, precise, and technically defensible documentation

We are engaged where precision matters, where failures have consequences, and where a true specialist, not a generalist, is required to deliver durable, risk-informed outcomes.



## 8. Director Profile

Hacène Baleh is a highly experienced engineering specialist with over 24 years of multidisciplinary practice in structural, civil, precast, forensic engineering, waterproofing, and concrete durability, with a strong focus on basements and below-ground structures.

A member of the Institution of Engineers Australia, he has delivered:

- 200+ waterproofing and remediation projects
- 400+ structural and infrastructure projects across Australia and internationally

His expertise includes failure investigation, performance-based design, and complex system integration across residential, commercial, and infrastructure assets. He is recognised for delivering solutions that are compliant, buildable, durable, and risk-informed under real site conditions.

His experience spans multiple states and territories of Australia, where he has designed waterproofing systems and remedial solutions, including precast concrete repair specifications for Transport for NSW (TfNSW).

Selected projects involving waterproofing designs for new builds, remedial of existing structures, precast concrete, structural and civil works, and concrete durability enhancement, include:

### Residential

- O’Dea Ave, Waterloo, NSW (2018 – New Structure – Precast Structural elements)
- Landenburg Pl, Greenwich NSW (2023 – Remedial Regulated Design – Waterproofing, Structural, Drainage)
- Billyard Ave, Elizabeth Bay NSW (2023 – Remedial Regulated Design Heritage – Waterproofing, Structural, Drainage)
- Regent St, Chippendale NSW (2023 – Remedial Regulated Design Mixed – Waterproofing, Structural, Drainage)
- Carrington Road, Randwick, NSW (2023 – Remedial Regulated Design Heritage – Waterproofing, Structural, Drainage)
- Underwood Rd, Homebush NSW (2025 – Remedial Regulated Design – Remedial for basements, Internal wet areas, balconies, terraces, and rooftop)
- Winning St, Kellyville NSW (2023 – Peer Review Defect within Builder’s warranty – Waterproofing, Structural, Drainage, facade)
- Marine Parade, Cottesloe, WA (Waterproofing and concrete durability Expert Design Review)
- Bunnerong Rd, Maroubra, NSW (2023 – Remedial Regulated Design – Waterproofing, Structural)
- Rockpool Apartments, Coolangatta, QLD (2019 – New Structure – Waterproofing)
- Rue Ighil Bouzel, Azazga, ALGERIA (2024 – New Structure – Structural, Civil, drainage, & Waterproofing).

### Commercial (Structural, repair, waterproofing)

- Burwood Road, Burwood, NSW
- Windsor Cook Freeze Facility, NSW
- Dee Why RSL Club, NSW
- Dreamworld, Wave Swinger, Coomera, QLD
- Marvel Hotel, Byron Bay, NSW
- Montessori Childcare, Randwick, NSW
- Aquatic Centre, Tullamarine, VIC

### Infrastructure (Structural & Civil UNO)





Burrill Lake Bridge, Burrill Lake, NSW.  
Homebush Bay Bridge, Homebush, NSW.  
Schofield Road upgrade, Schofields, NSW.  
WestConnex M4E ventilation system, NSW.  
Majura Parkway Bypass, ACT.  
CMRI at Westmead Hospital, NSW.  
Stages 1 & 2 of Blacktown Hospital, NSW  
Clarence Correctional Centre, Grafton, NSW.  
Sydney Football Stadium, Moore Park, NSW *(Waterproofing and concrete protection)*.  
The Northwest Rail Link, Rouse Hill, NSW.  
The Fontana Drive Bridge, Box Hill, NSW *(Waterproofing and concrete Repair)*  
Mega potable Water tanks, Solomon Islands *(Waterproofing)*  
Captain Cook Light House, Tweed Heads, NSW *(Waterproofing)*

### 1.1. Qualifications and Further Education

- 2002 - **Master of Engineering Studies**, University of Technology Sydney.
- 1997 - **Bachelor of Engineering**, University of Blida.
  
- 2023 - Australia National Construction Codes, Regulations and Compliance.
- 2022 - New BS8102.2022 update – Below-ground waterproofing by PCA England.
- 2021 - BS8102.2009 Below Grade Waterproofing by MacLennan Waterproofing England.
- 2021 - Waterproofing Design Principles, NSW Government.
- 2021 – Marine Concrete by CIA.
- 2020 – Concrete in the Marine Environment by CIA.
- 2020 - Watertight Concrete by PCA – England.
- 2016 - Changes to AS3850, Prefab Concrete Elements.
- 2012 - Reinforced Concrete Design Workshop.
- 2012 - Earthquake Design for Concrete Structures.
- 2008 - Designing Commercial Walls.
- 2007 - Precast for Structural Engineers.
- 2007 - Concrete Technology and Practice.
- 2000 - Certificate in AutoCAD 2D and 3D (Honours).
- 1999 - Certificate in Quality Management and Manufacturing Technology.

 02 8880 6750

 [info@balehconsulting.com.au](mailto:info@balehconsulting.com.au)

 115 Pitt St, Sydney NSW 2000

 [www.balehconsulting.com.au](http://www.balehconsulting.com.au)